



# ENG

## Quick Guide.

### Wireless earphones Features

- 5 V DC, 400 mA, 2.0 W
- Battery: 3.7 V, 320 mAh

### Package content

1. Earbuds
2. Charging case
3. Type (C) cable
4. Quick guide

### Battery charging

Charge the case using USB cable. LED is blinking during charging and turns to solid when topped up.

# BOS

## Kratti vodič.

### Bežične slušalice

#### Svojstva

- 5 V DC, 400 mA, 2.0 W
- Baterija: 3.7 V, 320 mAh

### Sadržaj paketa

1. Slušalice.
2. Kućica za punjenje
3. Tip (C) kabl
4. Brzi vodič

### Punjenje baterije

Napunite kućicu pomoću USB kabla. LED lampica treperi tokom punjenja i sveti kada se napuni.

Napunite slušalice tako što ćete ih

# BUL

## Kratto ръководство.

### Безжични слушалки

#### Характеристики

- 5 V DC, 400 mA, 2.0 W
- Батерия: 3.7 V, 320 mAh

### Съдържание на пакета

1. Слушалки.
2. Кулфа за зареждане
3. Тип (C) кабел
4. Кратко ръководство

### Зареждане на батерията

Заредете кулфа с помощта на USB кабел. Светодиодът мига по време на зареждане и става пълен, когато е зареден.

# CES

## Rychlý průvodce.

### Bezdrátová sluchátka

#### Funkce

- 5 V DC, 400 mA, 2.0 W
- Baterie: 3.7 V, 320 mAh

### Obsah balení

1. Sluchátka do uší.
2. Nabíječka pro náušníky
3. Kabel typu (C)
4. Stručný průvodce

### Nabíjení baterie

Nabíječka pomůže pomocí kabelu USB. Během nabíjení kontrolka LED bliká a po doplnění energie se změní na stálou.

# DEU

## Kurzanleitung.

### Kabellose Kopfhörer

#### Merkmale

- 5 V DC, 400 mA, 2.0 W
- Batterie: 3.7 V, 320 mAh

### Lieferumfang

1. Ohrstöpsel
2. Ladekoffer
3. Typ (C)-Kabel
4. Schnellanleitung

### Aufladen der Batterie

Laden Sie das Gehäuse mit dem USB-Kabel auf. Die LED blinkt während des Ladevorgangs und leuchtet, wenn der Akku aufgeladen ist.

# ELL

## Γρήγορος Οδηγός

### Ασύρματα Ακουστικά

#### Χαρακτηριστικά

- 5 V DC, 400 mA, 2.0 W
- Μπαταρία: 3.7 V, 320 mAh

### Περιεχόμενο συσκευασίας

1. Ακουστικά
2. Θήκη φόρτισης
3. Καλώδιο Type-C
4. Γρήγορος οδηγός

### Φόρτιση μπαταρίας

Φορτίστε τη θήκη χρησιμοποιώντας το καλώδιο USB. Το LED αναβοβλίζει κατά τη φόρτιση και γίνεται σταθερό όταν η φόρτιση ολοκληρωθεί.

# FRA

## Guide rapide.

### Écouteurs sans fil

#### Caractéristiques

- 5 V DC, 400 mA, 2.0 W
- Batterie : 3.7 V, 320 mAh

### Contenu de l'emballage

1. Écouteurs
2. Étui de chargement
3. Câble de type (C)
4. Guide rapide

### Chargement de la batterie

Chargez l'étui à l'aide du câble USB. Le LED clignote pendant la charge et devient fixe lorsque la batterie est rechargée.

# HUN

## Használati útmutató

### Vezetékes nélküli fülhallgató

#### Termékleírások:

- 5 V DC, 400 mA, 2.0 W
- Akkumulátor: 3.7 V, 320 mAh

### CSomag tartalma

1. Fülhallgató
2. Töltő tok
3. (C) típusú kábel
4. Gyors útmutató

### Az akkumulátor töltése

Töltsd fel a tokot USB-kábel segítségével. A LED villog a töltés alatt, és töltéskor állandóan világik.

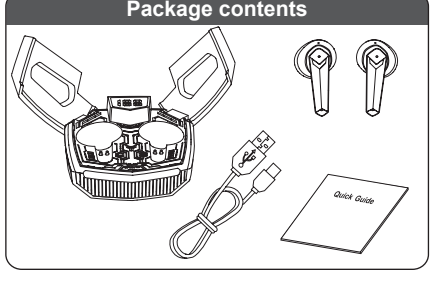

# ENG

## Quick Guide.

### Wireless earphones Features

- 5 V DC, 400 mA, 2.0 W
- Battery: 3.7 V, 320 mAh

### Package content

1. Earbuds
2. Charging case
3. Type (C) cable
4. Quick guide

### Battery charging

Charge the case using USB cable. LED is blinking during charging and turns to solid when topped up.

# BOS

## Kratti vodič.

### Bežične slušalice

#### Svojstva

- 5 V DC, 400 mA, 2.0 W
- Baterija: 3.7 V, 320 mAh

### Sadržaj paketa

1. Slušalice.
2. Kućica za punjenje
3. Tip (C) kabl
4. Brzi vodič

### Punjenje baterije

Napunite kućicu pomoću USB kabla. LED lampica treperi tokom punjenja i sveti kada se napuni.

Napunite slušalice tako što ćete ih

# BUL

## Kratto ръководство.

### Безжични слушалки

#### Характеристики

- 5 V DC, 400 mA, 2.0 W
- Батерия: 3.7 V, 320 mAh

### Съдържание на пакета

1. Слушалки.
2. Кулфа за зареждане
3. Тип (C) кабел
4. Кратко ръководство

### Зареждане на батерията

Заредете кулфа с помощта на USB кабел. Светодиодът мига по време на зареждане и става пълен, когато е зареден.

# CES

## Rychlý průvodce.

### Bezdrátová sluchátka

#### Funkce

- 5 V DC, 400 mA, 2.0 W
- Baterie: 3.7 V, 320 mAh

### Obsah balení

1. Sluchátka do uší.
2. Nabíječka pro náušníky
3. Kabel typu (C)
4. Stručný průvodce

### Nabíjení baterie

Nabíječka pomůže pomocí kabelu USB. Během nabíjení kontrolka LED bliká a po doplnění energie se změní na stálou.

# DEU

## Kurzanleitung.

### Kabellose Kopfhörer

#### Merkmale

- 5 V DC, 400 mA, 2.0 W
- Batterie: 3.7 V, 320 mAh

### Lieferumfang

1. Ohrstöpsel
2. Ladekoffer
3. Typ (C)-Kabel
4. Schnellanleitung

### Aufladen der Batterie

Laden Sie das Gehäuse mit dem USB-Kabel auf. Die LED blinkt während des Ladevorgangs und leuchtet, wenn der Akku aufgeladen ist.

# ELL

## Γρήγορος Οδηγός

### Ασύρματα Ακουστικά

#### Χαρακτηριστικά

- 5 V DC, 400 mA, 2.0 W
- Μπαταρία: 3.7 V, 320 mAh

### Περιεχόμενο συσκευασίας

1. Ακουστικά
2. Θήκη φόρτισης
3. Καλώδιο Type-C
4. Γρήγορος οδηγός

### Φόρτιση μπαταρίας

Φορτίστε τη θήκη χρησιμοποιώντας το καλώδιο USB. Το LED αναβοβλίζει κατά τη φόρτιση και γίνεται σταθερό όταν η φόρτιση ολοκληρωθεί.

# FRA

## Guide rapide.

### Écouteurs sans fil

#### Caractéristiques

- 5 V DC, 400 mA, 2.0 W
- Batterie : 3.7 V, 320 mAh

### Contenu de l'emballage

1. Écouteurs
2. Étui de chargement
3. Câble de type (C)
4. Guide rapide

### Chargement de la batterie

Chargez l'étui à l'aide du câble USB. Le LED clignote pendant la charge et devient fixe lorsque la batterie est rechargée.

# HUN

## Használati útmutató

### Vezetékes nélküli fülhallgató

#### Termékleírások:

- 5 V DC, 400 mA, 2.0 W
- Akkumulátor: 3.7 V, 320 mAh

### CSomag tartalma

1. Fülhallgató
2. Töltő tok
3. (C) típusú kábel
4. Gyors útmutató

### Az akkumulátor töltése

Töltsd fel a tokot USB-kábel segítségével. A LED villog a töltés alatt, és töltéskor állandóan világik.

## Package contents

Turn on the device: 2) Press the central button for 3 seconds. Switch ON/Off: Press and hold the central button for more than 5 seconds.

### Pairing

Take the earbuds out of the case and place them back in to the case to activate them. Then remove earbuds from the case again. If earbuds fall to auto power on when pairing, please charge them and try again.

### Switching ON/Off

Insert both earbuds into the charging case to activate them. LED is blinking during charging and turns to solid when topped up.

### Pairing

Take the earbuds out of the case and place them back in to the case to activate them. Then remove earbuds from the case again. If earbuds fall to auto power on when pairing, please charge them and try again.

### Switching ON/Off

Insert both earbuds into the charging case to activate them. LED is blinking during charging and turns to solid when topped up.

## Package contents

Turn on the device: 2) Press the central button for 3 seconds. Switch ON/Off: Press and hold the central button for more than 5 seconds.

### Pairing

Take the earbuds out of the case and place them back in to the case to activate them. Then remove earbuds from the case again. If earbuds fall to auto power on when pairing, please charge them and try again.

### Switching ON/Off

Insert both earbuds into the charging case to activate them. LED is blinking during charging and turns to solid when topped up.

## Package contents

Turn on the device: 2) Press the central button for 3 seconds. Switch ON/Off: Press and hold the central button for more than 5 seconds.

### Pairing

Take the earbuds out of the case and place them back in to the case to activate them. Then remove earbuds from the case again. If earbuds fall to auto power on when pairing, please charge them and try again.

### Switching ON/Off

Insert both earbuds into the charging case to activate them. LED is blinking during charging and turns to solid when topped up.

## Package contents

Turn on the device: 2) Press the central button for 3 seconds. Switch ON/Off: Press and hold the central button for more than 5 seconds.

### Pairing

Take the earbuds out of the case and place them back in to the case to activate them. Then remove earbuds from the case again. If earbuds fall to auto power on when pairing, please charge them and try again.

### Switching ON/Off

Insert both earbuds into the charging case to activate them. LED is blinking during charging and turns to solid when topped up.

## Package contents

Turn on the device: 2) Press the central button for 3 seconds. Switch ON/Off: Press and hold the central button for more than 5 seconds.

### Pairing

Take the earbuds out of the case and place them back in to the case to activate them. Then remove earbuds from the case again. If earbuds fall to auto power on when pairing, please charge them and try again.

### Switching ON/Off

Insert both earbuds into the charging case to activate them. LED is blinking during charging and turns to solid when topped up.

## Package contents

Turn on the device: 2) Press the central button for 3 seconds. Switch ON/Off: Press and hold the central button for more than 5 seconds.

### Pairing

Take the earbuds out of the case and place them back in to the case to activate them. Then remove earbuds from the case again. If earbuds fall to auto power on when pairing, please charge them and try again.

### Switching ON/Off

Insert both earbuds into the charging case to activate them. LED is blinking during charging and turns to solid when topped up.

## Package contents

Turn on the device: 2) Press the central button for 3 seconds. Switch ON/Off: Press and hold the central button for more than 5 seconds.

### Pairing

Take the earbuds out of the case and place them back in to the case to activate them. Then remove earbuds from the case again. If earbuds fall to auto power on when pairing, please charge them and try again.

### Switching ON/Off

Insert both earbuds into the charging case to activate them. LED is blinking during charging and turns to solid when topped up.

## Package contents

Turn on the device: 2) Press the central button for 3 seconds. Switch ON/Off: Press and hold the central button for more than 5 seconds.

### Pairing

Take the earbuds out of the case and place them back in to the case to activate them. Then remove earbuds from the case again. If earbuds fall to auto power on when pairing, please charge them and try again.

### Switching ON/Off

Insert both earbuds into the charging case to activate them. LED is blinking during charging and turns to solid when topped up.

## Package contents

Turn on the device: 2) Press the central button for 3 seconds. Switch ON/Off: Press and hold the central button for more than 5 seconds.

### Pairing

Take the earbuds out of the case and place them back in to the case to activate them. Then remove earbuds from the case again. If earbuds fall to auto power on when pairing, please charge them and try again.

### Switching ON/Off

Insert both earbuds into the charging case to activate them. LED is blinking during charging and turns to solid when topped up.

## Package contents

Turn on the device: 2) Press the central button for 3 seconds. Switch ON/Off: Press and hold the central button for more than 5 seconds.

### Pairing

Take the earbuds out of the case and place them back in to the case to activate them. Then remove earbuds from the case again. If earbuds fall to auto power on when pairing, please charge them and try again.

### Switching ON/Off

Insert both earbuds into the charging case to activate them. LED is blinking during charging and turns to solid when topped up.

## Package contents

Turn on the device: 2) Press the central button for 3 seconds. Switch ON/Off: Press and hold the central button for more than 5 seconds.

### Pairing

Take the earbuds out of the case and place them back in to the case to activate them. Then remove earbuds from the case again. If earbuds fall to auto power on when pairing, please charge them and try again.

### Switching ON/Off

Insert both earbuds into the charging case to activate them. LED is blinking during charging and turns to solid when topped up.

## Package contents

Turn on the device: 2) Press the central button for 3 seconds. Switch ON/Off: Press and hold the central button for more than 5 seconds.

### Pairing

Take the earbuds out of the case and place them back in to the case to activate them. Then remove earbuds from the case again. If earbuds fall to auto power on when pairing, please charge them and try again.

### Switching ON/Off

Insert both earbuds into the charging case to activate them. LED is blinking during charging and turns to solid when topped up.

## Package contents

Turn on the device: 2) Press



