

Cat.6A Patch Panel 8-Port, Shielded

Technical Features

Cat.6A 8-Port Patch Panel, Desktop

Cat.6A Class EA 10G 500MHz

Shielded RJ45 with gold flash contact

Metal Chassis

Supports PoE, PoE+ and PoE++

Art no.	Ports	Color	EAN Code
NP0018	8 Ports	RAL7035 Light Grey	4052792027747
NP0018B	8 Ports	RAL9005 Black	4052792038897



Technical Drawing

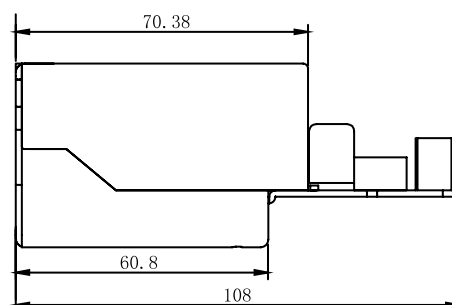
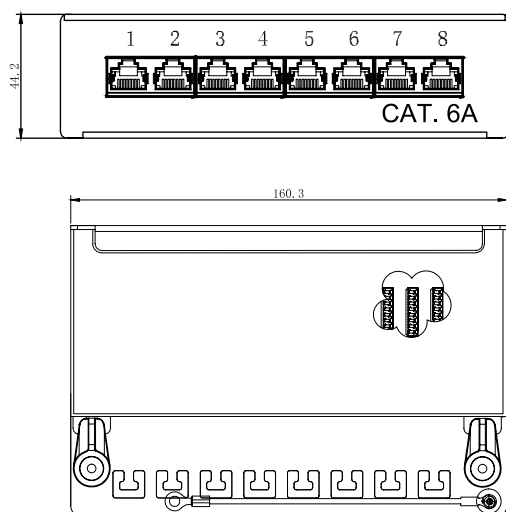

Package Content

Cat.6A Patch Panel 8-Port, Shielded x 1

Packaging Information

Packing Dimension	220 x 137 x 55mm
Packing Weight	0.68kg
Carton Dimension	450 x 290 x 290mm
Carton Q'ty	20pcs
Carton Weight	14.4kg (NP0018), 13.9kg (NP0018B)

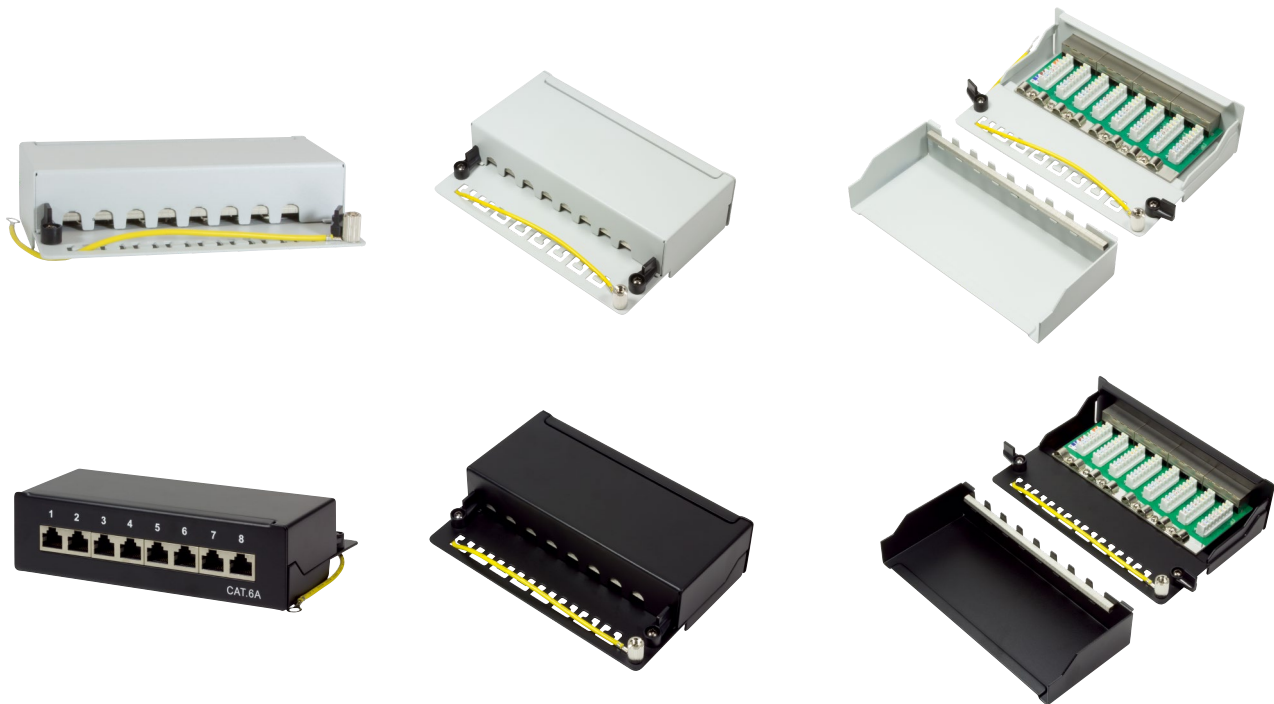

Made in China

www.logilink.com



RoHS
compliant

*The specifications and pictures are subject to change without prior notice.
*All trade names referenced are the registered trademarks of their respective owners.