

Safescan 45 LED / 55 LED / 75 LED UV Counterfeit Detector User Manual

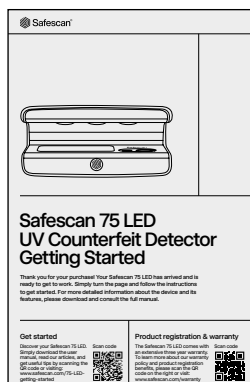

Print version
[Click here](#) to open a printable version of the manual in the selected language.

Package Content

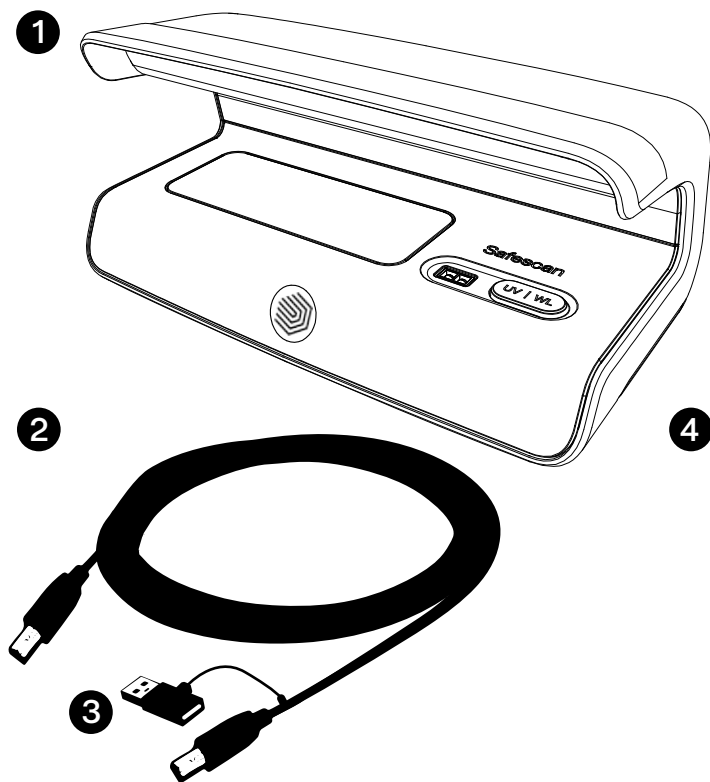

1. Safescan 45 LED / Safescan 55 LED / Safescan 75 LED
2. USB-C to USB-C power cable
3. USB-C to USB-A adapter
4. Get started folder

The Device

Front

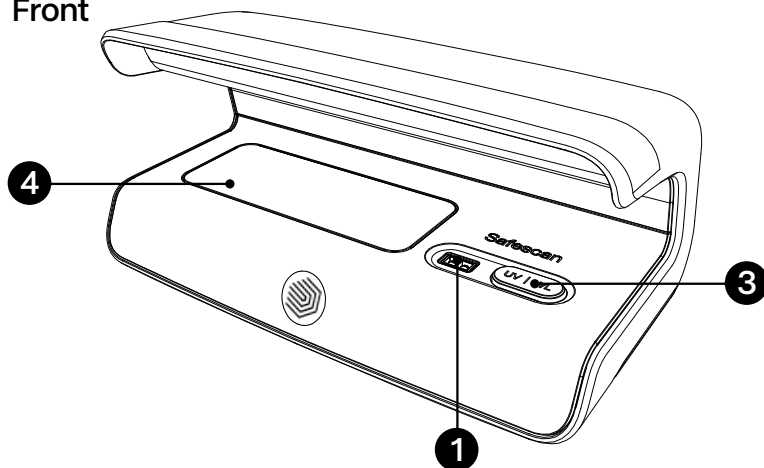

Back

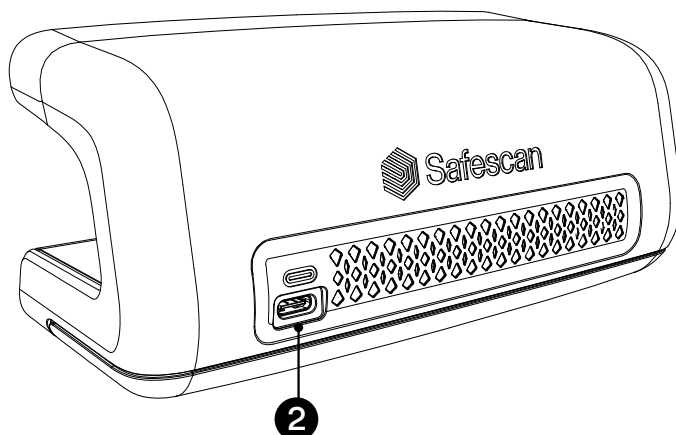

Safescan 45 LED
3. On/Off button
2. USB-C port

Safescan 55 LED
1. On/Off motion sensor
2. USB-C port

Safescan 75 LED
1. On/Off motion sensor
2. USB-C port
3. Light switch (UV/WL) button
4. White light area (WL)

Getting Started

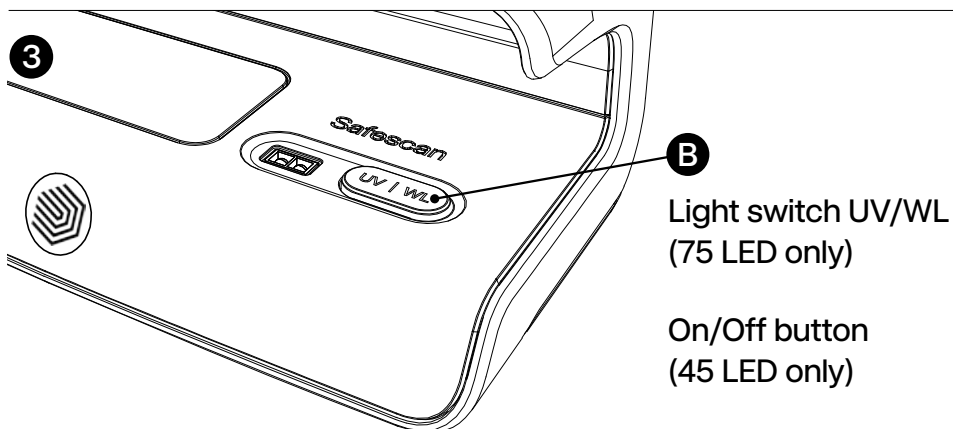
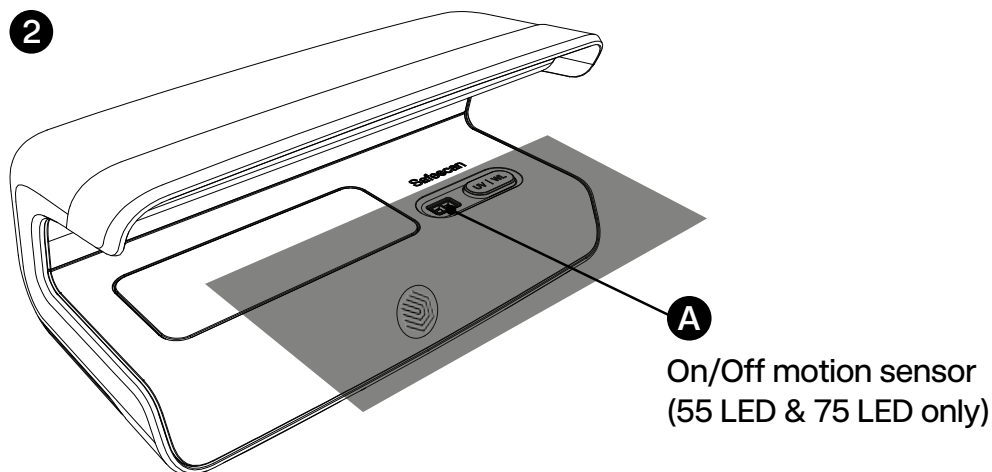
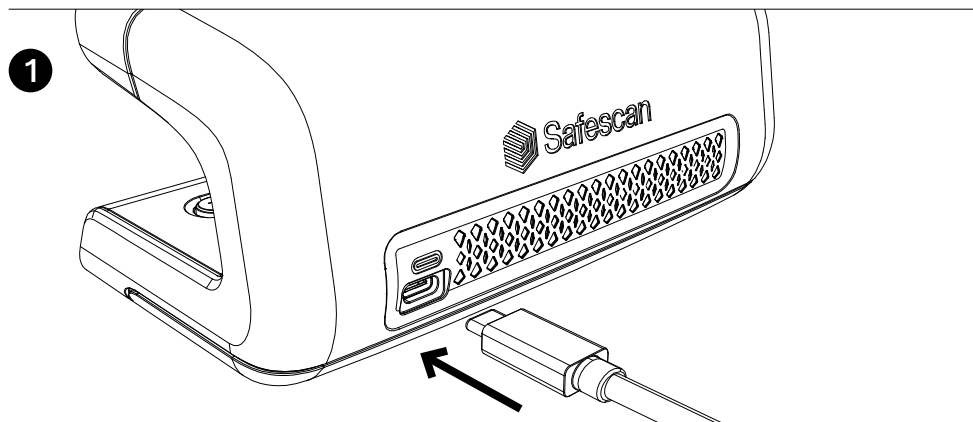

Safescan 45 LED

1. Connect the device to a USB power source using the supplied cable.
2. Press the On/Off button (B) to activate the ultraviolet light.

Safescan 55 LED

1. Connect the device to a USB power source using the supplied cable.
2. Place your item over the on/off motion sensor (A) to activate the ultraviolet light.

Safescan 75 LED

1. Connect the device to a USB power source using the supplied cable.
2. Place your item over the on/off motion sensor (A) to activate the device.
3. Press the light switch (B) to select ultraviolet or white light mode. The white light will highlight watermarks, metal threads, and microprints.

The Safescan 45 LED, Safescan 55 LED, and Safescan 75 LED can be used to check banknotes, credit cards, and identification documents.

Energy saving properties

Ultraviolet - UV (Safescan 55-75)

When the Safescan 55 LED or Safescan 75 LED is not used for more than five seconds it will automatically switch itself off. It will also do this if a banknote is placed under it for more than thirty seconds. In both cases, the device will turn back on as soon as movement is detected by the motion sensor.

White Light - WL (Safescan 75)

When the white light mode is activated, but the Safescan 75 LED is not used for more than ten seconds, it will automatically switch itself off. When an item is placed on the device for more than ten minutes, it will also automatically switch itself off. In both cases, the white light area will turn back on as soon as the motion sensor detects movement.

The Safescan 45 LED is optimized to have the lowest energy consumption possible without compromising detection qualities. Reduce your energy footprint even more by powering Off the device when not in use.

To learn more about how you can best check your currency, please visit the website of your region's central or local banks.

Safety Precautions

Warning!

Please carefully read and follow the listed safety precautions, as the incorrect use of your device can lead to injuries.

- Never stare directly into the ultraviolet light.
- Never use the cable if it is damaged.
- Never clean the device with liquids or chemical detergents.

Notice!

Please follow the instructions below to avoid damaging your device.

- Never open the device or take it apart.
- Do not use the device in dusty or dirty environments as this may impact the sensor quality.
- Unplug the device from its power source and store it somewhere safe if it will not be used for a longer period, to avoid damaging it.
- In case liquids are spilled on the device, always disconnect it from the power and contact Safescan for assistance.
- Always switch off the Safescan 45 LED when it is not being used.

Specifications

Dimensions (w x d x h):	171 x 90.6 x 81.6 mm 6.73 x 3.57 x 3.21 inch
Weight:	0.30 kg
Ambient temperature:	0°C - 40°C (32°F - 104°F)
Ambient humidity:	< 85%
Power source:	5V (USB-C)
Power consumption:	< 2W max.

3 year warranty

Warranty procedure: www.safescan.com



This product is in compliance with the essential requirements and other relevant provisions of the applicable European directives. The Declaration of Conformity (DoC) is available at www.safescan.com



Take the device to a recycling centre if you want to dispose of it. Never throw any electronic device away with the household waste.



This equipment has been tested and found to comply with the limits for a Class B digital device, pursuant to part 15 of the FCC Rules.

Safescan® is a registered trademark of Solid Control Holding B.V. No part of this manual may be reproduced in any form, by print, copy or in any other way without prior written permission of Solid Control Holding B.V. Solid Control Holding B.V. reserves all intellectual and industrial property rights such as any and all of their patent, trademark, design, manufacturing, reproduction, use and sales rights. All information in this manual is subject to change without prior notice. Solid Control Holding B.V. is not liable and/or responsible in any way for the information provided in this catalog. 20241